



37-39 Rose St  
 PO Box 1  
 MANJIMUP WA 6258  
<http://www.manjimup.wa.gov.au/>  
 P: (08) 9771 7777  
 E: info@manjimup.wa.gov.au

This plan is intended for internal Shire of Manjimup use only. It is not to be used as a site plan for planning, building or environmental health applications.

19/04/2024

1:7500



# CHERRY LANE FIELDS – PROPOSED ACCOMMODATION UNITS DEVELOPMENT AND SHED UPGRADE

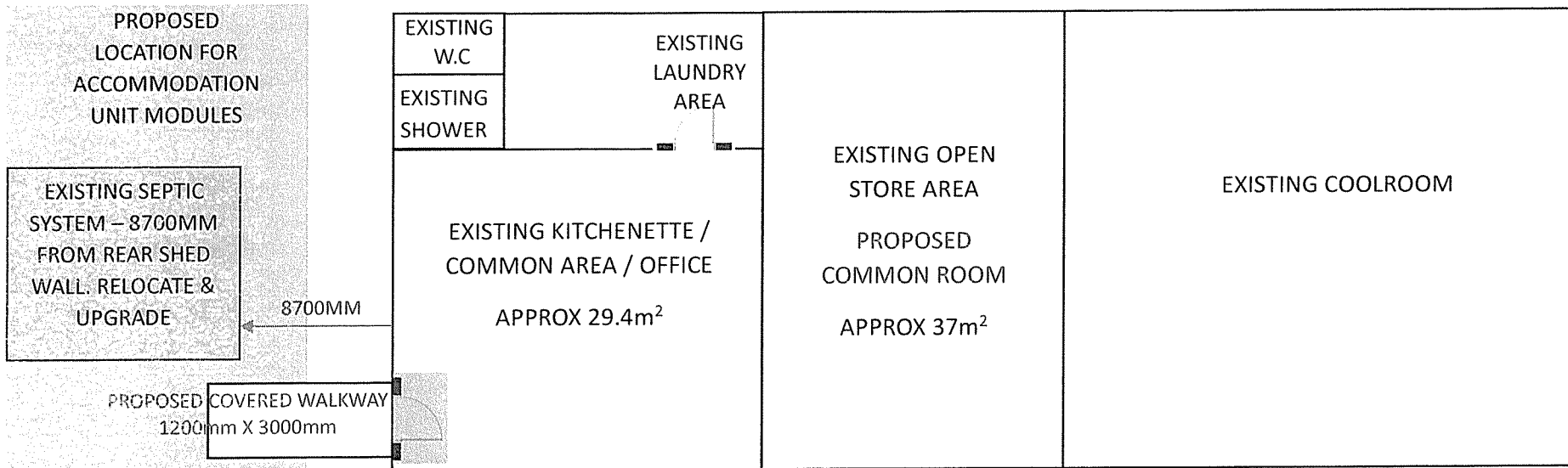

INSTALL NEW OPENING AND SOLID CORE DOOR TO EXISTING KITCHENETTE WALL. CONNECT NEW COVERED WALKWAY WITH CONCRETE PATH TO PROPOSED ACCOMMODATION UNITS.

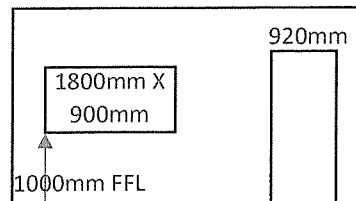

**PROPOSED COMMON ROOM ELEVATION**

**WORKS INCLUDE:**

- INSTALL TIMBER FRAMED, GYPROCK CLAD WALL
- INSTALL 1800mm X 900mm SLIDING WINDOW WITH SECURITY SCREEN
- INSTALL SOLID CORE ENTRY DOOR
- INSTALL DOUBLE CYLINDER LOCK & DOOR CLOSER

CHERRY LANE FIELDS – PROPOSED ACCOMMODATION UNITS DEVELOPMENT AND SHED UPGRADE SITE PLAN

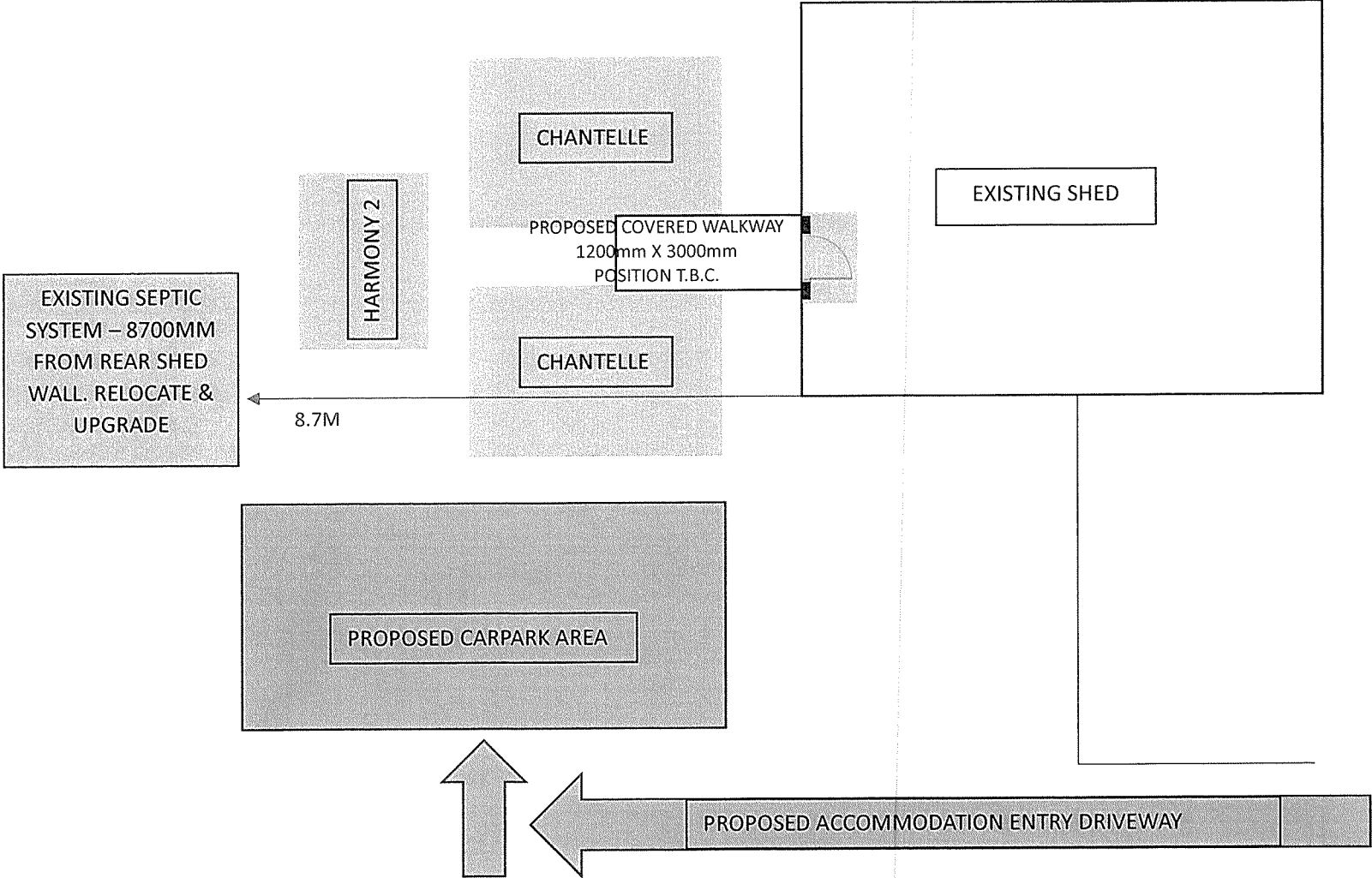

NOT TO SCALE